



**ORC**

Offshore Racing Congress  
World leader in rating technology

**2020  
ORC Club  
Certificate**

**Rating Office**

**Offshore  
Racing  
Congress**



**Certificate**

Number **1220.4**  
Issued On **29/01/2020**  
ORC Ref **03570000C1K**  
VPP Ver. **2020 1.00**  
Valid until **31/12/2020**

**Crew Weight**

Default 858kg  
Maximum **720kg**  
Minimum\* **540kg**  
*\*when applied by the NoR and SI*  
Non Manual Pwr

**Special Scoring**

	ToD	ToT
Non Spin GPH	<b>628.6</b>	<b>0.9545</b>
Non Spin OSN	<b>608.9</b>	<b>0.9854</b>

**Sails Limitations**

Headsails **6** Spinnakers **4**

**Spinnaker configuration**  
Symmetric: **Yes 124.89**  
Asymmetric: **No**  
Flying H/S: **No**  
Spin. Pole: **Yes**

**Class Division Length**

**CDL = 10.561**

**Stability (Measured)**

Limit Positive Stab.: **118.6°**  
Stability Index: **122.8**

**Owner**

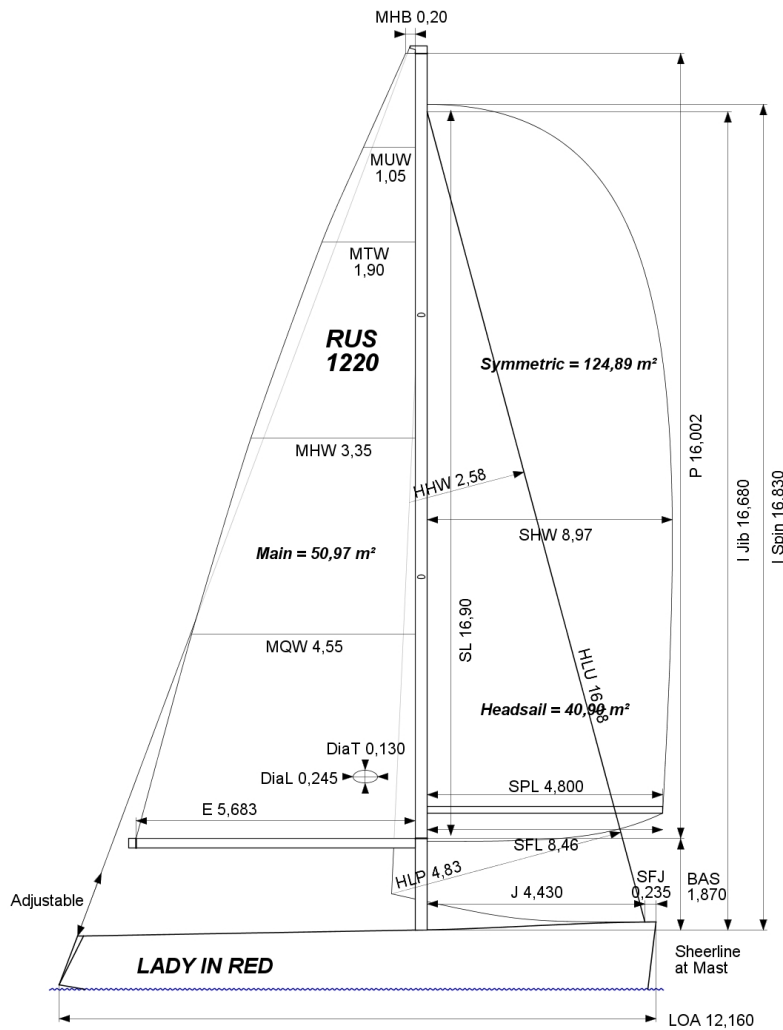

BOAT	GPH	HULL
Name <b>Lady in Red</b> Sail Nr <b>RUS 1220</b>	<b>588.0</b>	Data File <b>RU1220_LadyRe</b> LOA <b>12.160m</b> Offset File <b>Rik1220.off</b> MB <b>3.788m</b> Displacement <b>7,718kg</b> Draft <b>2.470m</b>
<b>CLASS</b> Class <b>Ricochet 1220</b> Designer <b>Ricochet Design Gr</b> Builder <b>Spray Ltd</b> Series <b>09/2006</b> Age Date <b>05/2011</b> Age Allowance <b>0.455%</b>		IMS Division <b>Cruiser/Racer</b> Dynamic All. <b>0.192%</b> Plan Review Construction <b>Solid</b> Fiber Rigging <b>No</b> Aramid Core <b>No</b> Crew Arm Ex Carbon Rudder <b>No</b> Light Stanchions
<b>COMMENTS</b> FFS. FAS adjusted to match DSPM=7740		IMSL <b>11.642m</b> VCGD <b>-0.054m</b> Sink <b>23.70kg/mm</b> RL <b>9.486m</b> VCGM <b>0.004m</b> WS <b>33.12m<sup>2</sup></b> LSM0 <b>11.666m</b> Displacement/Length ratio <b>4.8611</b>
<b>PROPELLER</b> Installation <b>Strut</b> PRD <b>0.380</b> Type <b>Folding 2 blades</b> PBW <b>0.100</b> PIPA <b>0.0036</b>		Water Ballast <b>0</b> Trim Tab <b>No</b> BLR Index <b>0.0000</b>
		<b>CENTERBOARD</b> <b>NA</b>
<b>SCORING OPTIONS</b>		
	<b>COASTAL / LONG DISTANCE</b>	<b>WINDWARD / LEEWARD</b>
Time on Distance	<b>571.7</b>	<b>639.8</b>
Time on Time	<b>1.0495</b>	<b>1.0550</b>
Triple Number	Low Medium High	Low Medium High
Time on Distance	<b>673.7 520.4 465.9</b>	<b>870.9 642.6 559.3</b>
Time on Time	<b>1.0020 1.2971 1.4488</b>	<b>0.7751 1.0505 1.2069</b>